

FULL SERVICE WITH THE EEZY 3 COMBINATION DEVICE

Tire pressure service

Step 1:

On the payment display of the Eezy Tower, select the desired service function and have your bank card ready for contactless payment. It's best to check the correct tire pressure for your vehicle in advance (the information is usually found on the inside edge of the driver's door, on the door pillar, inside the fuel cap, or in the owner's manual).

Now remove all valve caps and/or take the floor mats out of the vehicle.

After payment, the device starts automatically. You can switch between functions at any time by pressing a button.

Step 2:

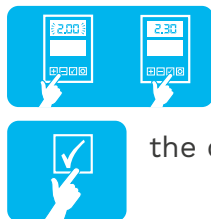

Use the + and – buttons to set the desired tire pressure (max. 5.5 bar) and then press the confirmation button.

Step 3:

Pull the air hose out of the device.

Step 4:

Firmly press the nozzle onto the valve of the tire you want to inflate. Inflation starts automatically. When the correct tire pressure is reached, a signal will sound.

Repeat this process for the remaining tires. If you change the preset pressure (e.g. for front and rear axles), the confirmation button must be pressed again to start. Once all tires have been checked and inflated, screw the valve caps back on.



For a completely flat tire, the filling process must be started manually. Use the button with the flat tire symbol.



You can check the current tire pressure without payment. Press the nozzle of the air hose onto the tire valve and read the value on the display.



FULL SERVICE WITH THE EEZY 3 COMBINATION DEVICE



Powerblower

Step 1:

On the payment display of the Eezy Tower, select the desired service function and have your bank card ready for contactless payment.

After payment, the device starts automatically. You can switch between functions at any time by pressing a button.

Step 2:

Use the left hose to blow away stubborn dust in hard-to-reach areas.

Step 3:

Place the nozzle back into the device when you are finished.



Vacuum cleaner

Step 1:

On the payment display of the Eezy Tower, select the desired service function and have your bank card ready for contactless payment.

After payment, the device starts automatically. You can switch between functions at any time by pressing a button.

Step 2:

Use the hose on the side of the device to clean floor mats, upholstery, and other textiles in your vehicle's interior.

Step 3:

Hang the vacuum hose back on the side of the device when finished.

In case of malfunction:
+49 (0) 461 9951370

Have a safe trip!

Here you will find information about the [privacy notice](#).

